

SHAFT COUPLINGS

SHEAR TYPE

BG SERIES



METAL HUBS JOINED BY PERMANENTLY BONDED ELASTOMER require no lubrication. Flexible in any direction—accommodates misalignment up to 1/32" parallel, 2° angular.

HIGH TORSIONAL DEFLECTION isolates low frequency vibration.

BORE SIZES FROM 1/8" TO 1"

COMPLETE WITH STANDARD SETSCREWS (Not installed).

ALL DIMENSIONS IN INCHES
ORDER BY CATALOG NUMBER OR ITEM CODE

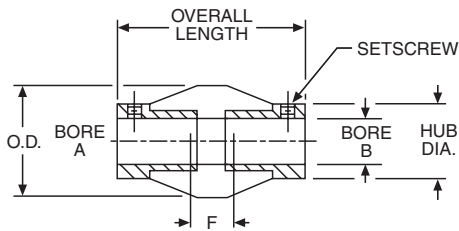

Coupling Size	Bore		Hub Dia.	O.D.	Overall Length	F*	Catalog Number	Item Code
	A	B						
BG47	1/8	1/8	7/16	9/16	13/16	3/16	BG47-2-2	49887
		3/16					BG47-2-3	49888
	1/4	BG47-2-4					49889	
BG11-1	3/16	3/16	5/8	13/16	1-3/8	11/32	BG11-1-3-3	49893
		1/4					BG11-1-3-4	49894
	5/16	BG11-1-4-4					49895	
BG11-2	1/4	1/4	3/4	1	1-3/4	13/32	BG11-2-4-4	49898
		5/16					BG11-2-4-5	49899
	3/8	BG11-2-4-6					49900	
BG11-3	5/16	5/16	7/8	1-1/4	2-1/8	15/32	BG11-2-5-5	49901
		3/8					BG11-2-5-6	49902
	1/2	BG11-2-6-6					49903	
BG11-4	3/8	3/8	1	1-3/8	2-1/4	17/32	BG11-3-5-5	49904
		1/2					BG11-3-5-6	49905
	5/8	BG11-3-5-8					49906	
BG11-5	1/2	1/2	1-1/8	1-5/8	2-1/2	19/32	BG11-3-6-6	49907
		5/8					BG11-3-6-8	49908
	3/4	BG11-3-8-8					49909	
BG11-6	5/8	5/8	1-3/8	1-13/16	2-11/16	11/16	BG11-4-6-6	49910
		3/4					BG11-4-6-8	49911
	1	BG11-4-6-10					49912	
BG11-7	3/4	3/4	1-1/2	2	2-7/8	3/4	BG11-4-8-8	49913
		7/8					BG11-4-8-10	49914
	1	BG11-4-10-10					49915	
BG11-1	1/2	1/2	1-1/8	1-5/8	2-1/2	19/32	BG11-5-8-8	49916
		5/8					BG11-5-8-10	49917
	3/4	BG11-5-8-12					49918	
BG11-2	5/8	5/8	1-3/8	1-13/16	2-11/16	11/16	BG11-5-10-10	49919
		3/4					BG11-5-12-12	49920
	1	BG11-6-8-8					49921	
BG11-3	1/2	1/2	1-3/8	1-13/16	2-11/16	11/16	BG11-6-8-12	49922
		3/4					BG11-6-10-10	49923
	5/8	BG11-6-10-12					49924	
BG11-4	3/4	3/4	1-1/2	2	2-7/8	3/4	BG11-6-12-12	49925
		7/8					BG11-7-8-12	49926
	1	BG11-7-10-10					49927	
BG11-5	5/8	5/8	1-1/2	2	2-7/8	3/4	BG11-7-12-12	49929
		3/4					BG11-7-12-14	49930
	1	BG11-7-16-16					49931	

STANDARD TOLERANCES

DIMENSION		TOLERANCE
BORE	1/8-3/8	+ .001 - .000
	1/2-5/8	+ .0015 - .000
	3/4-1	+ .002 - .000

REFERENCE PAGES

Alignment—148

LOAD DATA

HORSEPOWER AND TORQUE RATING AT RECOMMENDED SPEEDS FOR INSERTS INDICATED

Size	Maximum Horsepower Rating at RPM of *							Max Torque (Lb. Ins.)
	100	300	690	870	1150	1750	3450	
BG-47	.001	.003	.008	.010	.013	.020	.039	.72
BG11-1	.004	.011	.025	.031	.041	.062	.123	2.25
BG11-2	.007	.021	.049	.062	.082	.125	.246	4.50
BG11-3	.014	.043	.099	.124	.164	.250	.493	9.00
BG11-4	.019	.057	.131	.166	.219	.333	.657	12.00
BG11-5	.029	.086	.197	.248	.328	.500	.985	18.00
BG11-6	.043	.129	.296	.313	.493	.750	1.478	27.00
BG11-7	.057	.171	.394	.497	.657	1.000	1.971	36.00

*For uniform load.

*Shafts should not extend into "F" dimension.